

Federal Communications Commission Statement

This equipment has been tested and found to comply with the limits for a Class B digital device, pursuant to Part 15 of the FCC Rules. These limits are designed to provide reasonable protection against harmful interference in a residential installation. This equipment generates, uses, and can radiate radio frequency energy and, if not installed and used in accordance with the instruction, may cause harmful interference to radio communications. However, there is no guarantee that interference will not occur in a particular installation. If this equipment does cause harmful interference to radio or television reception, which can be determined by turning the equipment off and on, the user is encouraged to try and correct the interference by one of the following measures:

- Reorient or relocate the receiving antenna,
- Increase the separation between the equipment and receiver,
- Connect the equipment into an outlet on a circuit different from that to which the receiver is connected.

Consult the dealer or an experienced radio/TV technician for help.

This device complies with Part 15 of the FCC Rules. Operation is subject to the following two conditions: (1) this device may not cause harmful interference, and (2) this device must accept any interference received, including interference that may cause undesired operation.

FCC Caution: Any changes or modifications not expressly approved by the party responsible for compliance could void the user's authority to operate this equipment.

Limited Warranty

Vision Guarantees that every wireless siren & strobe alarm is free from physical defects in material and workmanship under normal usage for one year from the date of purchase. If the product proves defective during this one-year warranty period, Vision will replace it free of charge. Vision does not issue any refunds. This warranty is extended to the original end user purchase only and is not transferable. This warranty does not apply to: (1) damage to units caused by accident, dropping or abuse in handling, or any negligent usage; (2) units which have been repaired, taken apart, or modified by an unauthorized personnel; (3) units not used in accordance with instruction; (4) damages exceeding the cost of the product; (5) transit damage, initial installation costs, removal cost, or reinstallation cost.

For information on additional devices, please visit us at www.visionsecurity.com.tw



Installation & Operation Manual

ZM 1602 IN-5
ZM 1602 MY-5
ZM 1602 EU-5
ZM 1602 RU-5
ZM 1602 US-5
ZM 1602 IL-5
ZM 1602 KR-5
ZM 1602 HK-5
ZM 1602 JP-5
ZM 1602 BR-5

DC/AC Power Siren

Introduction

Thanks for choosing the Vision's wireless siren & strobe alarm of the home security device. This sensor is a Z-Wave™ enabled device (interoperable, two-way RF mesh networking technology) and is fully compatible with any Z-Wave™ enabled network and it's security framework. Every main powered Z-Wave™ enabled device acts as a signal repeater and multiple devices result in more possible transmission routes which helps eliminate "RF dead-spots".

Z-Wave™ enabled devices displaying the Z-Wave™ logo can also be used with it regardless of the manufacturer, and ours can also be used in other manufacturer's Z-Wave™ enabled networks. This product will sound a loud siren and flash a strobe light when an alarm message or alert is received on any Z-Wave™ enabled network. When ZM 1602 main power has dropped out, the backup batteries will automatically install. When the device is secure included into Z-Wave network, above communication will be encrypted.

Product Description and Specification

*** For indoor use only ***

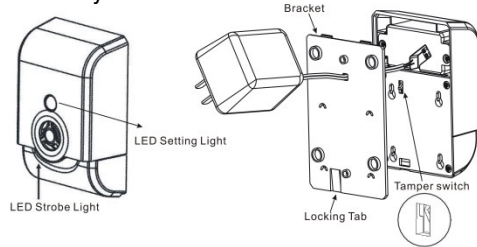

Specification:	Package Content:
Protocol: Z-Wave™ (ZM5202)	1pc ZM 1602 Siren
Frequency Range:	1pc Adhesive tape
865.22MHz (ZM1602IN-5)	2pcs Screw
868.10MHz (ZM1602MY-5)	1pc Installation & Operation Manual
868.42MHz (ZM1602EU-5)	Note: Power adapter excluded
869.00MHz (ZM1602RU-5)	
908.42MHz (ZM1602US-5)	
916.00MHz (ZM1602IL-5)	
919-923 MHz (ZF5201KR-5)	
919.80MHz (ZM1602HK-5)	
922 ~926MHz (ZF5201JP-5)	
921.42MHz (ZM1602BR-5)	
Operating Range: Up to 100 feet line of sight	
Loud Audible Alarm: > 105dB@1meter	
LED Strobe Lighting	
Operating Temp.: -15°C~ 60°C (5°F~140°F)	

Z-Wave Command Class:

-1-

COMMAND_CLASS_ASSOCIATION_V2
 COMMAND_CLASS_ASSOCIATION_GRP_INFO
 COMMAND_CLASS_CONFIGURATION
 COMMAND_CLASS_DEVICE_RESET_LOCALLY
 COMMAND_CLASS_FIRMWARE_UPDATE_MD_V2
 COMMAND_CLASS_MANUFACTURER_SPECIFIC_V2
 COMMAND_CLASS_NOTIFICATION_V4
 COMMAND_CLASS_POWERLEVEL
 COMMAND_CLASS_SECURITY
 COMMAND_CLASS_SWITCH_BINARY (Mapping COMMAND_CLASS_BASIC)
 COMMAND_CLASS_VERSION_V2
 COMMAND_CLASS_ZWAVEPLUS_INFO

Installation

Notice: If you are installing the entire Z-Wave™ system for the first time, please refer to the installation guide of Z-Wave™ Interface Controller before installing ZM1602.

1. Remove the bracket from the siren by press the locking tab, and then gently slide up the siren.
2. Remove two screws and pull out the plastic case as below. Pull out the short head & put back into the position where two pin heads are covered.

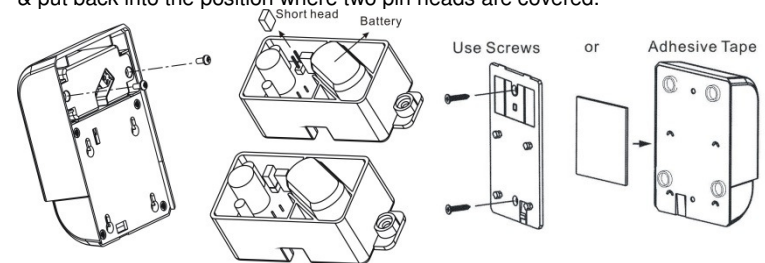

3. Knock out the thin wall on the bracket. Power line goes through the hole on bracket and connects to screw terminal on ZM1602.
4. Using the screws or adhesive tape to affix the bracket on the chosen location.
5. LED Status for Z-Wave Network:
 After power on, the LED Setting Light will flash if the siren has not been included yet.
 After power on, the LED Setting Light will go off if the siren has been included.
6. Slide back the cover and screw fastening with the front cover.
7. For "Inclusion" in (adding to) a network: Put the Z-Wave™ Interface Controller into "inclusion" mode, and following its instruction to add the ZM 1602 to your controller. To get in the "inclusion" mode, the distance between siren and controller is suggested to be in one meter. Open the bracket and press the program switch of ZM 1602 for 1 second at least & release to be included. After setting, the LED Setting Lighting should go off, if not, please try again. (After sending one time's Z-Wave NIF and not be included then it will send 4 times NWI in every 4 ~ 6 seconds for auto inclusion. The LED Setting Light will flash again if the siren has not

-2-

been included or the LED Setting Light will go off after inclusion.)

For **“Exclusion”** from (removing from) a network: Set up the Z-Wave™ Interface Controller into “exclusion” mode, and following its instruction to delete the ZM 1602 from your controller. Press the Tamper Switch of ZM 1602 for 1 second at least & release to be excluded.

Note:

- a. LED setting light will flash continuously in Exclusion condition.
- b. All user and network settings will be cleared and the device reset to factory defaults when the device is excluded.
- c. ZM 1602 can only connect to DC 12~39V, AC 9~28V Power adapter
- d. ZM 1602 is extremely LOUD, please don't near your ear when you test!

For **“Association”**: removing the back cover of the ZM1602 to get into “Awake” mode, then put the Z-Wave Interface Controller into “association”, and following its instruction to association the ZM1602 with other device. Close the back cover after “association” done, afterward the ZM1602 will get into “Sleep” mode for power saving. Support one association group (5 nodes).

8. Configuration command class:

	Byte	Value
Parameter 1 (Siren/Strobe Mode)	1	0 (All Enable) - Default 1 (Siren Only) 2 (Strobe Only)
Parameter 2 (Alarm Auto Stop Time)	1	0 (30s) - Default 1 (60s) 2 (120s) 3 (Will Not Automatically Stop)

(Parameter 1) Siren/Strobe Mode: User can change value from 0 to 2 to turn either Siren sound, Strobe light, or both when triggered.

(Parameter 2) Alarm Auto Stop Time: User can change the duration of siren time when triggered.

9. Support OTA Firmware update from controller. Please refer to your controller manual. We recommend to exclusive the device & inclusive again before use the device.
10. Repeater Function: This device acts as a repeater for the Z-Wave mesh network functionality.
11. All the rest commands depend on Z-Wave standard.

Operation

1. Normal operation, the LED light will not on.

2. **Alarm Mode:**

Active: It will active the Alarm Mode after receiving Basic Set (ON) or Binary Switch (ON). The LED Strobe Light & SIREN will be active according to the Configuration's setting value.

Stop: It will stop the Alarm Mode after receiving Basic Set (OFF) or Binary Switch (OFF) which depends on Configuration's setting value.

Auto Stop: After stopping alarm, it will send Binary Switch Report (0x00)

3. **Self-Protection Mode:** After put back the bracket over 5 seconds, ZM 1602 will enter the Self-Protection Mode which will active “LED Strobe Light & SIREN at the same time. The Alarm Mode will be triggered If the back cover has been opened during the Self-Protection Mode The Stop method is same as the Alarm Mode. Open the bracket or close the bracket after 5 seconds will sent notification

	Alarm Version 1	Notification Version 4
Alarm Type	0x03	
Alarm Level	0x00 (Non Trigger) / 0xFF (Trigger)	
Notification Type		0x07
Notification Event		0x00 (Non Trigger) / 0x03 (Trigger)

4. This device can't be reset manually. It is reset to factory defaults when it is excluded.
5. security enabled_ Z-Wave controller must be used to fully utilize the product.
6. Lifeline group used command :
{COMMAND_CLASS_NOTIFICATION_V4,NOTIFICATION_REPORT_V4}
{COMMAND_CLASS_DEVICE_RESET_LOCALLY,DEVICE_RESET_LOCALLY_NOTIFICATION}
7. Support Explorer Frame Function.