

MOVEZ

User manual

MOVEZ- Z-Wave controlled motor for indoor blinds and shades

Table of Content

1	WARNINGS AND GENERAL PRECAUTIONS FOR SAFETY	3
1.1	INSTALLATION WARNINGS	3
1.2	USE WARNINGS.....	3
2	REGULATORY AND SAFETY NOTICES	4
3	ABOUT THE PRODUCT	5
3.1	PRODUCT SPECIFICATIONS	5
3.2	PRODUCT IMAGES.....	5
4	INTEROPERABILITY	7
5	INCLUSION INTO THE Z-WAVE NETWORK	7
6	EXCLUSION FROM THE Z-WAVE NETWORK	7
7	SMARTSTART	7
8	FORCE RESETTING THE DEVICE	8
9	DEVICE BASIC FUNCTIONALITY	8
10	MULTILEVEL COMMAND CLASS IMPLEMENTATION	8
11	MULTILEVEL SWITCH COMMAND CLASS, VERSION 3.....	9
12	SUPERVISION COMMAND CLASS IMPLEMENTATION	9
13	ASSOCIATIONS	9
14	CONFIGURATION PARAMETERS	10
15	DEVICE CLASSIFICATION	11
16	SUPPORTED COMMAND CLASSES	11
17	FLIRS?.....	11
18	LOCAL SWITCH OPERATIONS.....	12
19	LOW BATTERY WARNINGS	12
20	LED INDICATIONS MAIN DEVICE	12
21	BATTERY PACK	13
22	ALTERNATIVE POWER SOURCE.....	13
23	SOLAR PANEL	13
24	CALIBRATION OF ENDPOINTS.....	14
25	INSTALLATION OF THE MOTOR AND THE ACCESSORIES	15
26	BEAD CHAIN INSTALLATION	16
26.1	MOUNTING BEAD CHAIN TO PULLEY	16
26.2	ATTACHING BEAD CHAIN	16
27	CORD LOOP INSTALLATION	17
27.1	MOUNTING CORD LOOP TO PULLEY	17
27.2	ATTACHING CORD LOOP	17
28	PLAIN CORD INSTALLATION	18
28.1	MOUNTING CORD TO THE SPOOL	18
28.2	ATTACHING CORD.....	18
29	WAYS TO GET CORRECT POSITION FOR INSTALLATION	19
30	INSTALL MOUNTING PLATE	21
31	ATTACH MAIN DEVICE TO MOUNTING PLATE	22
32	INSTALLING BATTERY PACK.....	23
33	DISPOSAL AND RECYCLING INFORMATION	24

1 Warnings and general precautions for safety

Read these warnings carefully before you continue installing, connecting and using MOVEZ hereinafter called the product. It is very important that you follow the safety and warning instructions written in this manual to ensure a safe use of the product. Keep these instructions. Heed all warnings. Only use the product as described in these instructions.

WARNING: Failure to follow these safety instructions could result in fire, electric shock, or other injury or damage to the product or other property.

1.1 Installation warnings

The product installation, collection programming and maintenance operations must be carried out exclusively by a qualified adult in observance of the instructions in this manual.

Before starting installation make sure the product can be retrofitted to your type of indoor blinds and shades. If not suitable do NOT proceed with installation. Make sure the product is able to run without risks of entangling, also make sure that anything in the vicinity is within such risk.

The product installation and maintenance operations must be performed with all power sources disconnected from MOVEZ.

Install the product out of reach for children. The product shall not and cannot replace the purpose of a child safety product for indoor blinds and shades. The product and its accessories may contain small parts. Keep them away from small children.

It is very important NOT to use the product with battery power if it must be placed in direct sunlight or near other heat sources, in high temperatures batteries can be dangerous. In these conditions always remove the batteries and use a suitable USB power adapter to power the product. Exact specification for the USB power adapter can be found in this manual. Read all safety instructions for any other products and/or accessories before using with the product. Teptron AB is not responsible for the operation of, or any damage caused by, third-party accessories or their compliance with safety and regulatory standards.

During installation, handle the product with care - avoid crushing, impact, dropping or contact with liquids - never place the product near sources of heat or expose to naked flames. All these actions could damage the product and cause malfunctions or dangerous situations.

Pay attention to your personal safety in regard to proper use of ladders. Be careful when handling tools from an extended height, do not drop them. Do not drop the product. If dropped or damaged do not install it. Be aware of that a dropped product may not have visibly detectable damage.

Be very careful when handling knives, scissors or similar sharp cutting tools.

Do not install the product to outdoor shading products, its only intended to be applied to indoor blinds and shades.

Do not dismantle the product other than described in this manual. Do not make any changes to any part of the product except those indicated in this manual. Do not insert anything in the product except what's described in this manual. The manufacturer declines all liability for damage caused by makeshift modifications to the product.

Before connecting a power adapter, batteries or blinds and shades to the product, carefully read the warnings and the product manuals of those products, and it's important to only use approved certified products.

When connecting a power adapter to the product do not use a damaged power cord or plug and do not use loose or damaged power outlets. Unplug power adapter during lightning storms or when unused for long periods of time.

Protect the power cord from being walked on or pinched, particularly at plugs, convenience receptacles, and the point where they exit from the apparatus.

1.2 Use warnings

Do not operate the product when jobs are being performed in the vicinity i.e. window cleaning, maintenance jobs, etc. Disconnect the all power supplies to the product before starting such jobs. Be aware of operating the product when your window is open. Outside circumstances may cause damage to the product and the surroundings.

Keep the product out of reach for children. The product may attract attention of children and animals. During operation children and animals should be kept away from the device.

Do not pull the cord, cord loop or bead chain when the product is attached to and installed in active or passive mode.

Wash yourself immediately if exposed to battery acid.

Always shield the product from direct sunlight regardless of power source.

Make sure that your burglar alarm does not trigger because of movement from your blinds or shades

After commissioning, the batteries are trickle-charged by electrical energy generated by the solar panel. The energy produced by the solar panel is stored in Li-iron batteries. It is normal for the battery to gain more energy in summer as compared to winter. The solar panel converts the intensity of light to energy when available.

If the motor does not operate due to an excessively diminished battery, the battery pack may require a full recharge by battery charger that is approved by manufacture. If the battery no longer provides adequate power to operate the motor, new rechargeable battery pack should be installed.

Always read instructions on how to install and remove battery pack to and from MOVEZ main device.

Never force a connector into a port when using connectors and ports. Check for obstructions on the port. If the connector and port don't join with reasonable ease, they probably don't match. Make sure that the connector matches the port and that you have positioned the connector correctly in relation to the port.

Refer all servicing to qualified service personnel. Service is required when the apparatus has been damaged in any way, such as when the solar panel cord or plug is damaged, liquid has been spilled or objects have fallen into the apparatus, the apparatus has been exposed to rain or moisture, dose not operate normally, or has been dropped.

Do not use the product in rain, or near washbasins or other wet locations and avoiding water and wet locations. Take care not to spill any food or liquid on the product. In case the product gets wet, unplug all cables and remove the battery before cleaning, and allow it to dry thoroughly before turning it on again. Do not attempt to dry the product with an external heat source, such as a microwave oven or hair dryer. Damage to the product caused by contact with liquid is not covered by the manufacturer.

2 Regulatory and safety notices

Model name: MZ1811

FCC warnings:

FCC Statement:

Any Changes or modifications not expressly approved by the party responsible for compliance could void the user's authority to operate the equipment.

This device complies with part 15 of the FCC Rules. Operation is subject to the following two conditions:

- (1) This device may not cause harmful interference.
- (2) This device must accept any interference received, including interference that may cause undesired operation.

FCC Radiation Exposure Statement:

This equipment complies with FCC radiation exposure limits set forth for an uncontrolled environment. This equipment should be installed and Operated with minimum distance 20cm between the radiator & your body.

ISED RSS Warning/ISED RF Exposure Statement:

ISED RSS Warning:

This device complies with Innovation, Science and Economic Development Canada licence-exempt RSS standard(s). Operation is subject to the following two conditions: (1) this device may not cause interference, and (2) this device must accept any interference, including interference that may cause undesired operation of the device.

Le présent appareil est conforme aux CNR d'ISED applicables aux appareils radio exempts de licence. L'exploitation est autorisée aux deux conditions suivantes:

- (1) l'appareil ne doit pas produire de brouillage, et
- (2) l'utilisateur de l'appareil doit accepter tout brouillage radioélectrique subi, même si le brouillage est susceptible d'en compromettre le fonctionnement.

ISED RF exposure statement:

This equipment complies with ISED radiation exposure limits set forth for an uncontrolled environment. This equipment should be installed and operated with minimum distance 20cm between the radiator& your body.This transmitter must not be co-located or operating in conjunction with any other antenna or transmitter.

Le rayonnement de la classe b respecte ISED fixaient un environnement non contrôlés.Installation et mise en oeuvre de ce matériel devrait avec échangeur distance minimale entre 20 cm ton corps.Lanceurs ou ne peuvent pas coexister cette antenne ou capteurs avec d'autres.

European Union (EU)

Declaration of Conformity with Regard to the EU Directive 1999/5/EC

Teptron AB is authorized to apply the CE Mark on MOVE, model name: MOVE MZ1811, thereby declaring conformity to the essential requirements and other relevant provisions of Directive 1999/5/EC.

Compliant with the standard R&TTE 99/CE/05

Conforme à la norme R&TTE 99/CE/05

Konform mit dem Standard R&TTE 99/CE/05

3 About the product

MOVEZ is intended exclusively for the automation of various types of indoor blinds and shades. MOVEZ is a motor for existing indoor blinds and shades. It is built to fit as many different manually controlled indoor blinds and shades as possible. Therefore the motor can be retrofitted to nearly all different manually controlled indoor blinds and shades.

No matter if its continuous cord loops, bead chain loop, bead chain with connectors or just reeling in a cord MOVEZ will be able to operate it. MOVEZ is installed enclosed wall bracket.

MOVEZ uses a Z-Wave radio and it is a Security (S2) & SmartStart enabled Z-Wave Plus Product. It uses S2 UNAUTHENTICATED SECURITY CLASS as its highest level of security. Hence a Security Enabled Z-Wave Controller must be used in order to avail security features of the product.

3.1 Product specifications

- Main power source: Rechargeable battery pack
- Alternate power source: AC to DC switch mode power supply with output regulated to DC 8V 1.3A and a micro USB type B connector
- Radio protocol: Z-wave
- Motor torque: $\approx 1\text{Nm}$ (lift/pull capacity: 10kg/22lb)
- Size MOVEZ device: Length 110mm, width 38mm, height 49mm
- Size Battery device: Length 78mm, width 38mm, height 49mm
- Size solar panel: Length 238mm, Width 55mm
- Weight: 350

3.2 Product images



Picture 1-Product picture

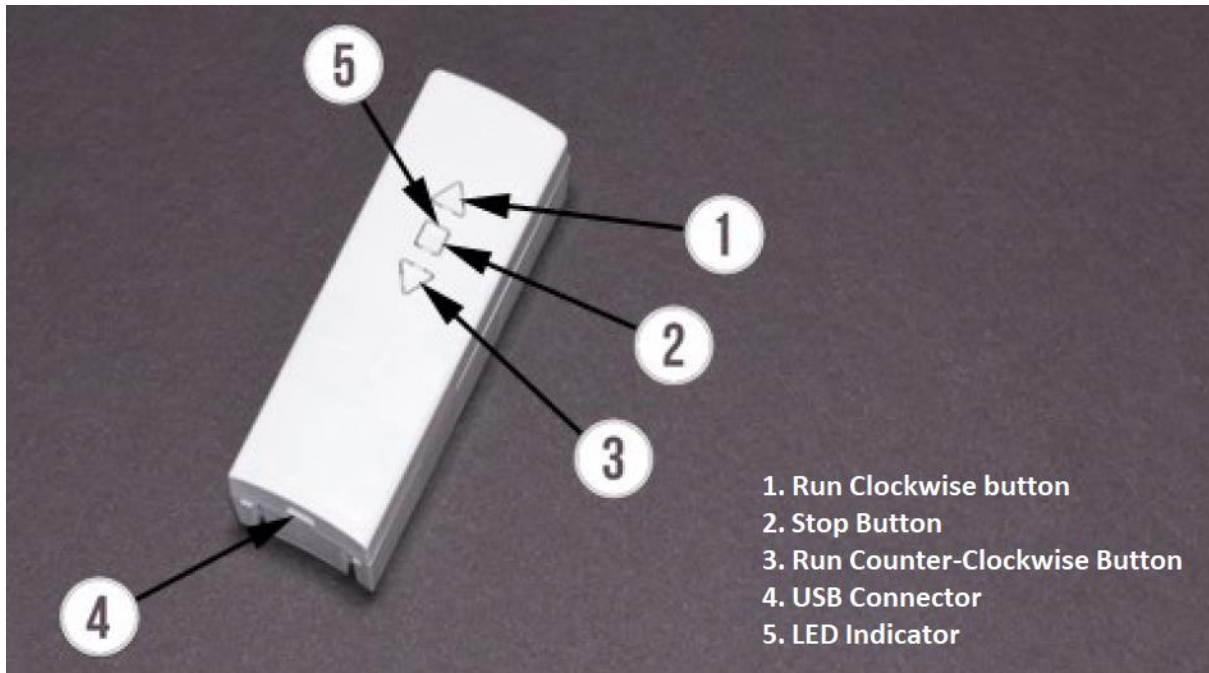

Picture 2-Main device

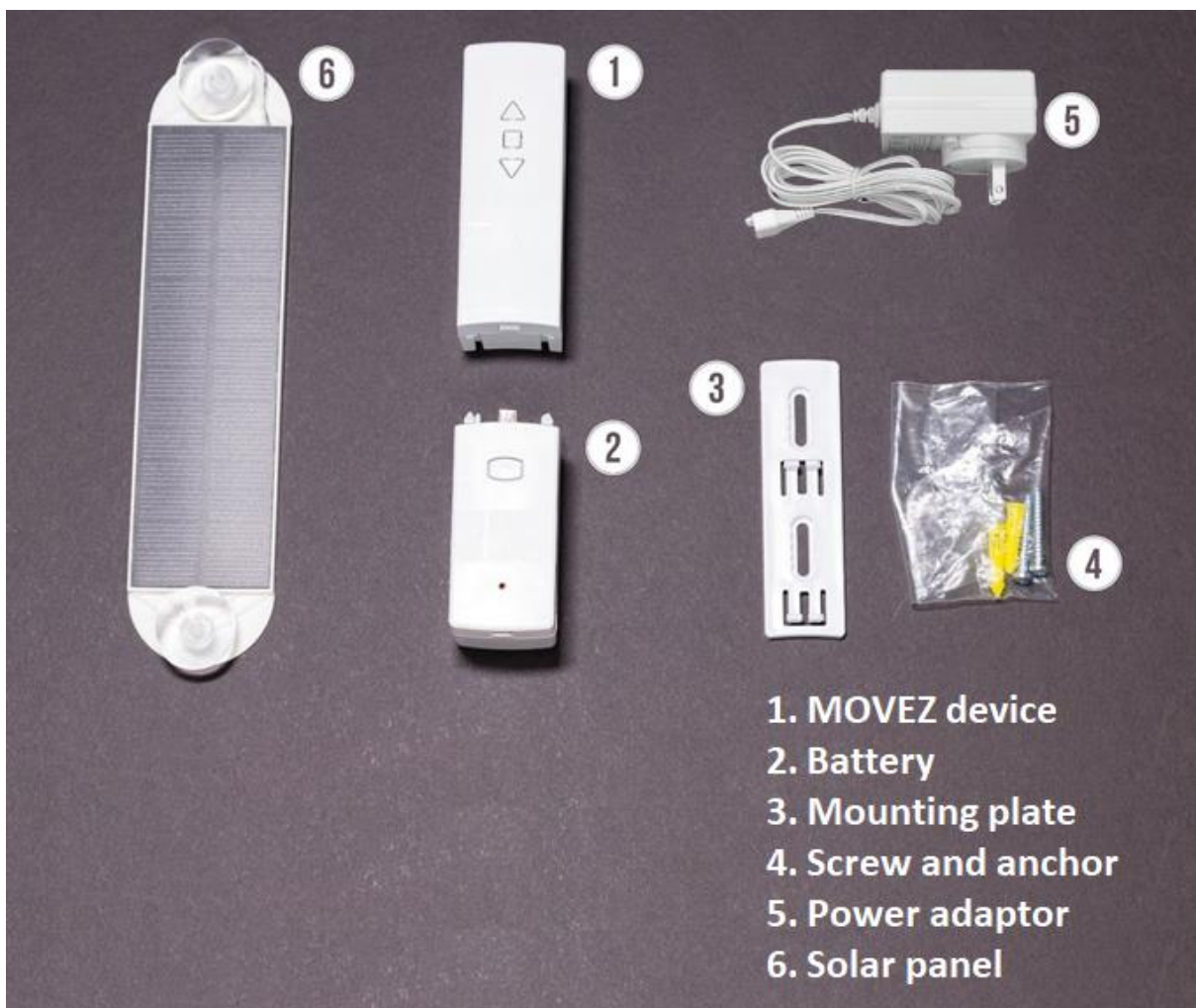

Picture 3-Parts

4 Interoperability

This product can be operated in any Z-Wave network with other Z-Wave certified devices from other manufacturers. All non-battery-operated nodes within the network will act as repeaters regardless of vendor to increase reliability of the network.

5 Inclusion into the Z-Wave network

Inclusion is a process by which a new device (or a device which previously got out of Z-Wave network by force reset or exclusion process) can join a new or existing Z-Wave network. Including procedure is shown below. Note: The term “INCLUSION”, “ASSOCIATE”, “ADDING”, “PARING” implies to the same meaning.

Inclusion procedure explained below,

1. Set the gateway into inclusion mode (See gateway’s product manual for more information).
2. Set MOVEZ into learn mode. Learn mode is set by press and holding stop button (picture 2, position 2) for 10 plus seconds. Once both red and green led indicator start blinking together (picture 2, position 5), release stop button to issue node information frame.
3. Because device supports **S2 Unauthenticated** Class gateway may ask for an option of secure or non-secure inclusion. Please select this as per your preference.
4. Green led blink twice once inclusion process is successfully completed.

6 Exclusion from the Z-Wave network

Exclusion is a process by which an already included device can be made to leave its existing Z-wave network. Upon exclusion all user configuration parameters are set to their default values. Note: The term “EXCLUSION”, “REMOVING”, “UNPARING” implies to the same meaning.

Exclusion procedure explained below,

1. Set gateway into the exclusion mode (See gateway user manual for more information)
2. Set MOVEZ into learn mode. Learn mode is set by press and holding stop button (picture 2, position 2) for 10 plus seconds. Once both red and green led indicator start blinking together (picture 2, position 5), release stop button to issue node information frame.
3. Red led blink twice once exclusion process is successfully completed.

7 SmartStart

Z-Wave SmartStart is a feature that removes the need for initiating the end device to start inclusion. With SmartStart Inclusion is initiated automatically on power-ON and repeated at dynamic intervals for as long as the device is not included into a Z-Wave network.

As the new device announces itself on power-ON, the protocol will provide notifications, and the gateway can initiate the inclusion process in the background, without the need for user interaction or any interruption of normal operation. This improvement also removes the possibility of other devices being included, as the SmartStart inclusion process only includes authenticated devices. A gateway supporting SmartStart has a provision list for adding device DSKs. As this device supports S2_UNAUTHENTICATED class of security, DSK or QR code not required for manual inclusion of the device into the network, DSK or QR code is only needed when SmartStart feature is being used. DSK or PIN code can be found on the backside of the device as well as on the packaging box. Do not remove the “Z-Wave pin code” label from the product.

8 Force resetting the device

The device has a provision to RESET itself. Once the device resets, it will no longer be a part of Z-Wave network and all the user configuration parameters are set to their default values. Controller will be informed about this event with `COMMAND_CLASS_DEVICE_RESET_LOCALLY` command via lifeline group so that node cleaning operation can be started.

Device Reset can be invoked by press and holding stop button (picture 2, position 2) for 20 plus seconds. Once both red and green blinking leds (picture 2, position 5) becomes stable ON release stop button.

Blinking of red led twice indicates that reset operation is successful.

Note: Red and green leds starts blinking after 10 plus seconds to indicate inclusion or exclusion can be activated at that point if button is released.

9 Device basic functionality

MOVEZ implemented with the support of Basic Command Class so that legacy devices can be able to control MOVEZ with basic functionality. Below is the mapping shown,

Basic Set = 255 maps to Multilevel Switch Set = 99 (if value of configuration parameter 03, is set to 1)

Basic Set = 255 maps to Multilevel Switch Set = Last known non-zero value. (if value of configuration parameter 03, is set to 0). See configuration parameters section for more information. Default last known value is 100%.

Basic Set = 0 maps to Multilevel Switch Set = 0

Basic Set = 1-99 maps to Multilevel Switch Set = 1-99

Basic Get/Report maps to Multilevel Switch Get/Report

Basic CC also supports securely.

10 Multilevel Command Class implementation

When sending a multilevel report to the gateway MOVEZ follow the below pattern,

Current value field always reports current position of the device reading from the hardware.

Target value field reports 99 if motor is moving towards opening and reports 0 if motor is moving towards closing and reports same value as “Current value” when motor is not moving.

Duration field reports “Unknow Duration” if motor is moving in either direction and reports “Already at the target value” if motor is not rotating.

Duration field of `SWITCH_MULTILEVEL_SET` and `WITCH_MULTILEVEL_START_LEVEL_CHANGE` command cannot be used as limitation of this multilevel device that cannot make instant transitions to any location.

Value field of `MULTILEVEL_SET` version 4 command if received as `0xFF`, will set curtain to last known non-zero position. Default last known value is 100%.

Ignore Start Level field and **Primary Switch Start Level** fields of `SWITCH_MULTILEVEL_START_LEVEL_CHANGE` command is ignored.

11 Multilevel Switch Command Class, Version 3

As Secondary Switch Type of the Multilevel Switch Command Class, version 3 has been DEPRECATED. Secondary type switch, all its associated fields are also ignored. This device supports only primary switch as Open/Close.

Ignored fields are,

- “Secondary Switch Inc/Dec” field of SWITCH_MULTILEVEL_START_LEVEL_CHANGE command.
- “Secondary Switch Step Size” field of SWITCH_MULTILEVEL_START_LEVEL_CHANGE command.

12 Supervision Command Class Implementation

As this device supports S2 security class, Supervision command class is implemented for high level security reporting.

Because **duration** field is unknown when motor running MOVEZ follow the below reporting pattern,

- If motor is moving in either direction, an immediate report will be sent with,
 1. **Status** filed reports “Working” with **More Status Updates** bit set to 1.
 2. **Duration** field reports “Unknown Duration”.
 3. After motor stops
 4. **Status** filed reports “Success” with **More Status Updates** bit set to 0.
 5. **Duration** field reports “Already at the target value”.
- If motor is not moving an immediate report will be sent with,
 1. **Status** field reports “Success” with **More Status Updates** bit set to 0.
 2. **Duration** field reports “Already at the target value”.

13 Associations

MOVEZ supports association command class with two association groups,

GROUP 01: Lifeline group, this group can accommodate only one node. Usually a gateway’s node ID configured automatically by the gateway during interview process. All the system related communications like force resetting device, low battery warning, curtain position (if changed locally via buttons) are notified to the gateway through lifeline group.

GROUP 02: This group is to control its destination nodes using BASIC and MULTILEVEL command class. Group 02 can accommodate maximum of five devices. Commands issued via this group can be configured using configuration parameter 04, which is explained below, (See configuration parameters section for more information).

Configuration parameter 04 Value 00 (Default)		
Botton/Action	HOLD	RELEASE
UP Button	Basic Set FF	--
Down Button	Basic Set 00	--

Table 1

Configuration parameter 04 Value 01		
Botton/Action	HOLD	RELEASE
UP Button	Multilevel Set FF	Stop Level Change
Down Button	Multilevel Set 00	Stop Level Change

Table 2

Configuration parameter 04 Value 02		
Botton/Action	HOLD	RELEASE
UP Button	Start Level Change UP	Stop Level Change
Down Button	Start Level Change DOWN	Stop Level Change

Table 3

14 Configuration Parameters

MOVEZ support user configuration parameters so that user can set their preferences.

Parameter #01 – Set motor's up speed	
Size	1 byte (decimal)
Range	1 to 100
Default value	100
Description: Configures the up speed of the motor, 1=lowest and 100=highest speed.	

Table 4

Parameter #02 – Set motor's down speed	
Size	1 byte (decimal)
Range	1 to 100
Default value	100
Description: Configures the down speed of the motor, 1=lowest and 100=highest speed.	

Table 5

Parameter #03 – Basic Set 0xFF support	
Size	1 byte (decimal)
Range	0 to 1
Default value	1
Description: The value of the parameter decides the behavior of BASIC SET support. Motor position sets to last known non-zero value if value this parameter is set to 0. Motor position set to 100% if value this parameter is set to 1.	

Table 6

Parameter #04 – Association group 02 control command preference	
Size	1 byte (decimal)
Range	0 to 2
Default value	0
Description: The value of this parameter decides control commands to be used for association group 02. See Table 1,2, and 3 for more information.	

Table 7

15 Device Classification

MOVEZ classified under,

Generic Device Class – GENERIC_TYPE_SWITCH_MULTILEVEL

Specific Device Class – SPECIFIC_TYPE_CLASS_C_MOTOR_CONTROL

16 Supported Command Classes

- Non-Secure
 - COMMAND_CLASS_ZWAVEPLUS_INFO (Ver 02)
 - COMMAND_CLASS_SUPERVISION (Ver 01)
 - COMMAND_CLASS_TRANSPORT_SERVICE (Ver 02)
 - COMMAND_CLASS_SECURITY_2 (Ver 01)
- Secure
 - COMMAND_CLASS_SWITCH_MULTILEVEL (Ver 04)
 - COMMAND_CLASS_ASSOCIATION (Ver 02)
 - COMMAND_CLASS_VERSION (Ver 03)
 - COMMAND_CLASS_ASSOCIATION_GRP_INFO (Ver 01)
 - COMMAND_CLASS_MANUFACTURER_SPECIFIC (Ver 02)
 - COMMAND_CLASS_DEVICE_RESET_LOCALLY (Ver 01)
 - COMMAND_CLASS_POWERLEVEL (Ver 01)
 - COMMAND_CLASS_CONFIGURATION (Ver 01)
 - COMMAND_CLASS_BATTERY (Ver 01)

17 FLIRS?

A key feature of the popular Z-Wave wireless communications protocol that's particularly relevant to designers of battery powered devices, as well as other home automation and security devices is the power-saving FLiRS operating mode.

Without FLiRS, battery-powered smart devices would be impractical. FLiRS, which stands for Frequently Listening Receiver Slave allows the product designer to set the desired wakeup performance while optimizing battery life. FLiRS also employs unique beaming technology that provides for transition from sleep to fully awake modes on the order of one second, a critical performance requirement for battery powered devices that must be communicated with at any time with short latency.

With reliable, robust performance field-tested in thousands of homes, the Z-Wave protocol is the best choice for battery-powered door locks and many other home automation applications.

18 Local switch operations

It will be possible to click on either the up or the down button (picture 2, position 1 and 3) to make MOVEZ go to the respective end positions. MOVEZ can always be stopped by clicking the stop button at the device. This is true no matter if the initial run command originates from the push/click of buttons “up” or “down” or from the radio.

19 Low battery warnings

Low battery warning will be issued by the MOVEZ to the gateway twice via Lifeline group. First report will be issued when battery level goes below 20% and second report will be issued when battery level goes below 10%.

Note: Along with every low battery warning notification MOVEZ also sends current battery report.

20 LED Indications main device

Red LED	Green LED	Meaning
OFF	Blink fast	Device in calibration mode
Blink fast	Blink fast	Device can enter learn mode
ON	ON	Device can do force reset operation
OFF	Blink 2 times at power ON	Device inclusion completed. At bootup this blink indicate that the device is included
Blink 2 times at power ON	OFF	Device exclusion completed or reset operation is successful. At bootup this blink indicate that the device is not included
Blink 1 time	OFF	Too low power to start motor, further execution of position command is stopped
Blink 2 times	OFF	New position command received while still executing another command, motor will stop
Blink 3 times	OFF	Motor stall protection stop
Blink 4 times	OFF	Wall safety switch in wrong position and motor will stop

Table 8

21 Battery pack

It is not possible to disassemble the MOVEZ battery pack. The battery pack can either be charge while still attached to the main device or detached from the main device as a standalone device.

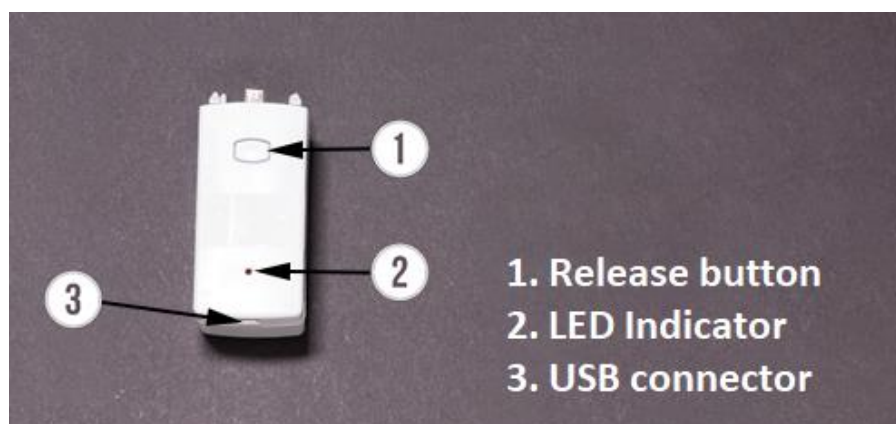

Picture 4-Battery

The release button (picture 4, position 1) is used when detaching the battery pack from the MOVEZ device.

The led indicator (picture 4, position 2) can have the following states:

LED state	Meaning
Stable ON	Charging
Blinking	Error indication
Off	Fully charged or not plugged in

Table 9

The battery pack can be charged with any standard 0.5A USB power adapter source.

Charging starts when a USB power adapter is attached to the battery pack.

It will take about 13 hours to fully charge a battery and because the charger is smart it will automatically turn off when the battery is fully charged no matter status before charging starts. This means charge time can be less than 13 hours if the battery is not completely empty when charging starts. When the charging is complete the indicator led will be off.

22 Alternative power source

The alternative power source that can be used is an AC to DC, switch mode power supply with output regulated to DC 8V 1.3A and a micro USB type B connector. When this is used the battery pack is not needed.

23 Solar panel

The solar panel must always be installed indoors. Insert the cable from the solar panel to the battery device USB connector (picture 4, position 3).

24 Calibration of endpoints

MOVEZ is calibrated with the physical buttons (picture 2, position 1, 2 and 3). Because MOVEZ can be installed in many ways the buttons up (picture 2, position 1) and down (picture 2, position 3) can make the product on which MOVEZ is installed on run in different directions depending on installation. After the endpoints are set the buttons at the device will however be correct and always give correct action.

The two buttons up and down will make the motor either go to up (Open, ON or position 100) endpoint or down (Close, OFF or position 0) endpoint.

Calibration of “up” (Open, ON or position 100). This is the maximum open position.

Procedure explained below,

1. Push and hold in the stop button (picture 2, position 2).
2. With the stop button pushed in, push and hold in the up button (picture 2, position 1).
3. Let go of both buttons. The led indicator (picture 2, position 5) will then blink slow green to indicate that the device is in calibration “up” mode. Use the up and down buttons to set the maximum “up” position. The “up” position is the position when the product on which MOVEZ is installed at **DOSE NOT cover the window.**
4. When the desired “up” position is found click the stop button. The position will now be saved, and the blinking will stop.

Calibration of “down” (Close, OFF or position 0). This is the maximum closed position.

Procedure explained below,

1. Push and hold down the stop button (picture 2, position 2).
2. With the stop button pushed in, push and hold in the down button (picture 2, position 3).
3. Let go of both buttons. The led indicator (picture 2, position 5) will then blink rapid green to indicate that the device is in calibration “down” mode. Use the up and down buttons to set the maximum “down” position. The “down” position is the position when the product on which MOVEZ is installed at **DO cover the window.**
4. When the desired “down” position is found click the stop button. The position will now be saved, and the blinking will stop.

25 Installation of the motor and the accessories

Check the condition of MOVEZ upon unpacking it, do not install if damaged.

Check if MOVEZ is compatible with the product you intend to install it on before installing, do not install if it's not compatible.

Make sure the product you intend to install MOVEZ on is working correct and don't have any defects, do not install if there are any defects.

The motor inside MOVEZ has a torque of about 1Nm and incorrect installation and/or usage can be dangerous.

Make sure that the cord or bead chain of the product you intend to install MOVEZ on is compatible, do not install if it does not fit.

Before installing MOVEZ make sure that there is enough free space in the window for MOVEZ to operate freely, do not install if there is a possibility that things can get caught and tangled in by the motor motion.

Only mount MOVEZ according to instructions in this manual.

Warning! - Before starting, carefully read the warnings under section 1. It is important that you install MOVEZ as described in this manual to ensure safe use of the motor.

26 Bead Chain Installation

Important! If the bead chain has a connector make sure that the bead chain connector is running smoothly with metal pulley.

Many different sizes of bead chain and connectors exist and MOVEZ is designed to fit as many as possible, but compatibility to make sure MOVEZ fits the product it's about to be installed on need to be established before installation.

26.1 Mounting bead chain to pulley

The bead chain needs to be taut enough, so the bead chain doesn't skip metal pulley.



Picture 5-Bead chain pulley

26.2 Attaching bead chain



Picture 6-Bead chain

27 Cord Loop Installation

When installing the cord loop it's important to make sure the center hole in the spool lines up correctly with the hole on the motor output axel. The metal pieces that are bent around the cord loop center hole should grip the motor output axel.

27.1 Mounting cord loop to pulley

The cord needs to be taut enough, so the cord doesn't slip in the cord loop spool.



Picture 7-Cord loop pulley

27.2 Attaching cord loop



Picture 8-Cord loop

28 Plain Cord Installation

Products that are operated by just pulling a cord need some preparation in order for MOVEZ to operate them.

1. Remove all plastic parts from the cord
2. After removing the plastic parts make a knot on the end of the cord



Picture 9-Preparing cord

28.1 Mounting cord to the spool



Picture 10-Attaching to spool

28.2 Attaching cord



Picture 11-Cord spool

29 Ways to get correct position for installation

Option 1

Use a template to mark-up the location for the device.



Figure 12-Mounting plate mark-up

Option 2

Use the mounting plate to mark-up the location of the device.

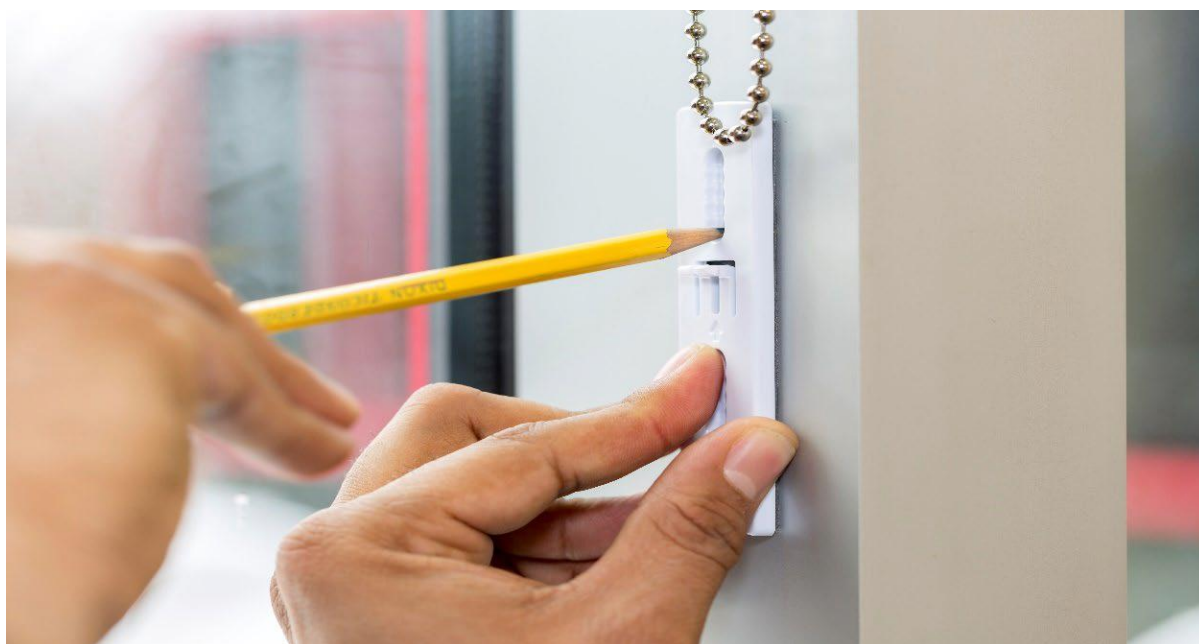

Picture 13-Mounting plate

The wall mounting plate used to attach the MOVEZ to the wall.

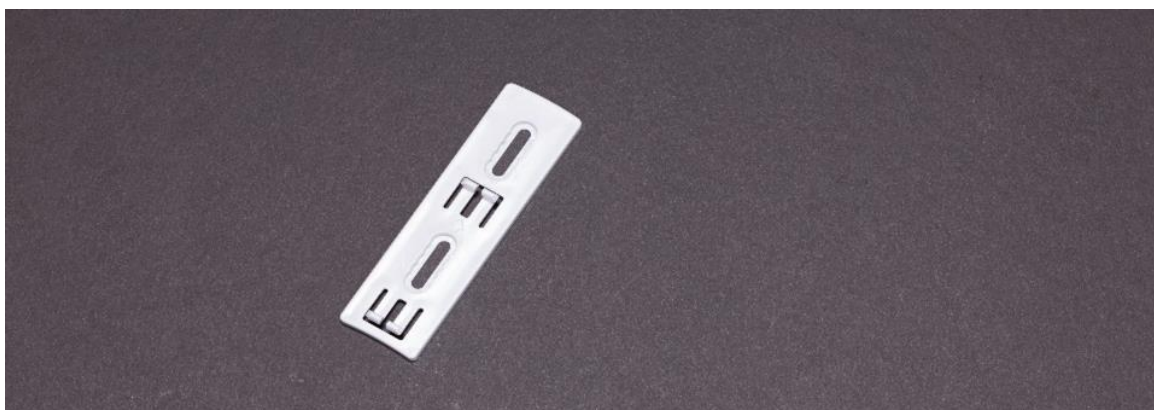

Picture 14- Mounting plate

Use screws and anchor to attach mounting plate to wall.



Picture 15- Fastener

30 Install mounting plate

Locate the correct mounting plate position and use Philips screwdriver or drill to install it. If the wall plug is used a hole need to be drilled before insertion of the plug and then use of the screw.



Picture 16-Fixing Mounting plate

Attach the bead chain to main device pulley as shown on picture below.

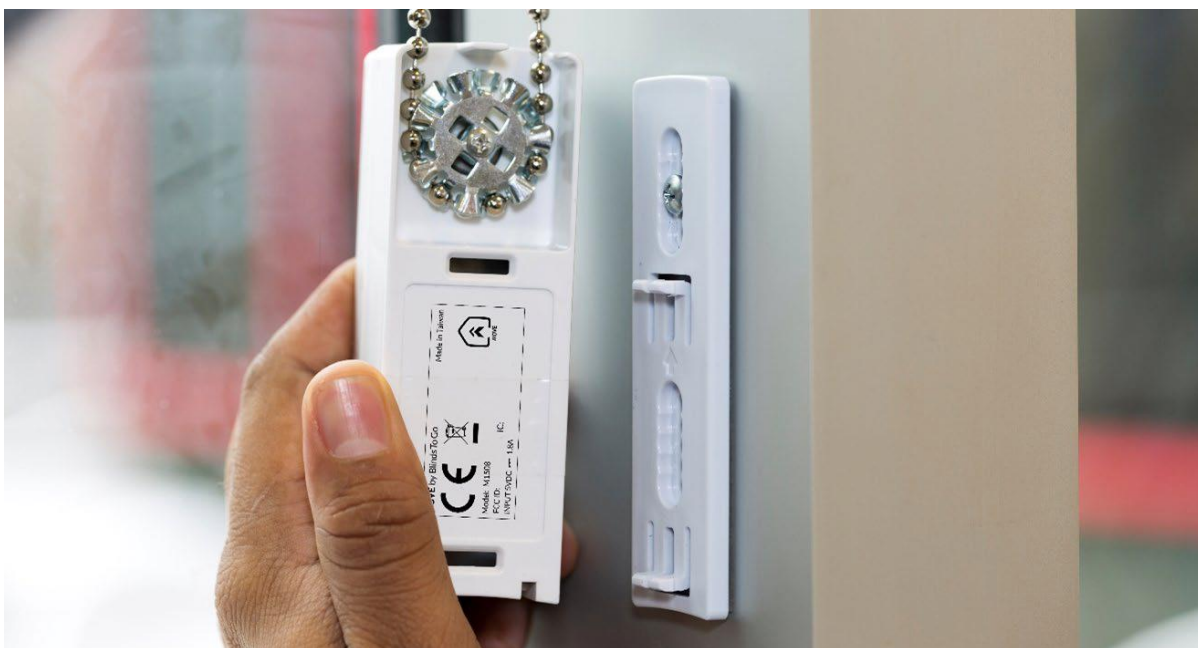

Picture 17-Attaching main device

31 Attach main device to mounting plate

Push main device towards the mounting plate to attach the main device to the wall mounting plate.



Picture 18-Fixing main device



Picture 19-Fixed main device

32 Installing battery pack

Make sure to align the battery pack to main device and push it from underneath. Battery pack connection should line up with main device connection.



Picture 20-Attaching battery pack



Picture 21-Attached battery pack

33 Disposal and recycling information

You must dispose of MOVEZ properly according to local laws and regulations. Because MOVEZ contains electronic components, MOVEZ must be disposed of separately from household waste. When MOVEZ reaches its end of life, contact local authorities to learn about disposal and recycling options, or simply drop it off at your local Teptron retail store or return it to Teptron.

MOVEZ packaging materials must be disposed of in full compliance with local regulations.



European Union—Disposal Information

The symbol above means that according to local laws and regulations your product and/or its battery shall be disposed of separately from household waste. When this product reaches its end of life, take it to a collection point designated by local authorities. The separate collection and recycling of your product and/or its battery at the time of disposal will help conserve natural resources and ensure that it is recycled in a manner that protects human health and the environment.

Union Européenne—informations sur l'élimination: Le symbole ci-dessus signifie que, conformément aux lois et réglementations locales, vous devez jeter votre produit et/ou sa batterie séparément des ordures ménagères. Lorsque ce produit arrive en fin de vie, apportez-le à un point de collecte désigné par les autorités locales. La collecte séparée et le recyclage de votre produit et/ou de sa batterie lors de sa mise au rebut aideront à préserver les ressources naturelles et à s'assurer qu'il est recyclé de manière à protéger la santé humaine et l'environnement.

Europäische Union—Informationen zur Entsorgung: Das oben aufgeführte Symbol weist darauf hin, dass dieses Produkt und/oder die damit verwendete Batterie den geltenden gesetzlichen Vorschriften entsprechend und vom Hausmüll getrennt entsorgt werden muss. Geben Sie dieses Produkt zur Entsorgung bei einer offiziellen Sammelstelle ab. Durch getrenntes Sammeln und Recycling werden die Rohstoffreserven geschont und es ist sichergestellt, dass beim Recycling des Produkts und/oder der Batterie alle Bestimmungen zum Schutz von Gesundheit und Umwelt eingehalten werden.

Unione Europea—informazioni per lo smaltimento: Il simbolo qui sopra significa che, in base alle leggi e alle normative locali, il prodotto e/o la sua batteria dovrebbero essere riciclati separatamente dai rifiuti domestici. Quando il prodotto diventa inutilizzabile, portalo nel punto di raccolta stabilito dalle autorità locali. La raccolta separata e il riciclaggio del prodotto e/o della sua batteria al momento dello smaltimento aiutano a conservare le risorse naturali e assicurano che il riciclaggio avvenga nel rispetto della salute umana e dell'ambiente.

Europeiska unionen—information om kassering: Symbolen ovan betyder att produkten och/eller dess batteri enligt lokala lagar och bestämmelser inte får kastas tillsammans med hushållsavfallet. När produkten har tjänat ut måste den tas till en återvinningsstation som utsetts av lokala myndigheter. Genom att låta den uttjänta produkten och/eller dess batteri tas om hand för återvinning hjälper du till att spara naturresurser och skydda hälsa och miljö.