



IlluminEssence™
IN-WALL DIMMER
MLIWD600S
DESIGNER SERIES

**INSTALLATION
& USER GUIDE**

MONSTER® ILLUMINESSENCE™ PRODUCTS:



Dimmable
Table & Floor Lamps

Plug In Light Station Dimmer MLLD 300



ON/OFF
Compact Fluorescent Lights
& Appliances

Plug In Light & Appliance
Station Dimmer MLLAS 1000



Dimmable
Ceiling Lights
Table & Floor Lamps

In Wall Dimmer MLIWD 600S



ON/OFF
Ceiling Fluorescents
Table & Floor Lamps

In Wall Switch MLIWS 1000S



Controls All or Selected
Lights at the Push
of a Button

In Wall Scene Controller MLIWC 600

INTRODUCTION

MONSTER® ILLUMINESSENCE™: POWERFUL WHOLE HOME LIGHTING CONTROL MADE SIMPLE

The Monster IlluminEssence™ dimmers, switches and controllers communicate with each other via Monster ControlNet™, a wireless Radio Frequency (RF) technology that provides whole-house remote control over your home lighting without the need for new wiring or custom installation. Each station in the Monster IlluminEssence lighting component line has on board memory to remember programmed scene settings and also acts as its own wireless router. These routers transmit the wireless RF signals from one device to another until the intended device is reached and controlled according to the user's preferences. This ensures that the signal is received by its intended device by routing the signal around obstacles and radio dead spots. Thanks to this innovative routing system and wireless RF ControlNet, IlluminEssence modules can work

through floors, walls, ceilings and cabinets. IlluminEssence scene-capable dimmer modules are compatible with any Z-Wave™ enabled network, regardless of the manufacturer, and can also be used with other devices displaying the Z-Wave logo.

WARNINGS AND CAUTIONS:

- Do not exceed the 600W rating as shown on the safety label.
- Dimmer may not operate with dioded lamps (Sylvania Designer 16™ or Philips PAR-16™).
- Total minimum load must exceed 40W.

Monster Recommends that you remember to exercise good common sense when using any timer features in a remote-controllable system, especially when scheduling unattended devices. There can be some unexpected consequences if not used with care. For example, an empty coffee pot can be remotely turned on. If that should happen, your coffee pot could be damaged from overheating. If an electric heater is turned on by remote control while clothing

- Dimmer may feel warm to the touch during normal operation.
- Recommended minimum wall box depth is 2-1/2".
- Disconnect power at circuit breaker or fuse when servicing, installing or removing fixture.
- Use this device only with copper or copper clad wire. With aluminum wire use only devices marked CO/ALR or CU/AL.
- To be installed and/or used in accordance with appropriate electrical codes and regulations.

is draped over it, a fire could result. **DO NOT USE** the IlluminEssence In Wall or Plug In Light Stations for the control of high power heating appliances such as portable heaters. This device will not control lighting that is used with electronic low-voltage and high frequency power supply transformers, nor high pressure discharge lamps (HID lighting). This includes mercury-vapor, sodium vapor and metal halide lamps.

- If you are unsure about any part of these instructions, consult a qualified electrician.
- This device is intended for indoor use only.

TOOLS NEEDED TO INSTALL YOUR ILLUMINESSENCE™ IN-WALL DIMMER:

- Slotted/Phillips Screwdriver
- Electrical Tape
- Pliers
- Pencil
- Cutters (If Necessary)
- Ruler

PREPARE FOR INSTALLATION

- Make sure that there is plenty of task lighting (or natural sunlight) to work in the room you would like to install IlluminEssence™ lighting so that you don't find yourself performing installation with inadequate light.
- Please confirm that electrical load
4 does not exceed 600W. Check to see

if existing in wall switch/dimmer already in place is controlling less than 600W before proceeding with installation.

- **It is important to ensure that all circuit breakers are turned OFF prior to installation!** To do this, follow these steps:
 - 1) Start by turning ON the in-wall dimmers and/or switches that you intend to replace with IlluminEssence in-wall light stations.
 - 2) Find your home circuit breaker panel and turn off the appropriate labeled breakers for the room that you plan to be installing IlluminEssence in-wall light stations.
 - 3) Return to the room and CONFIRM that the electricity is turned off. Remove the existing decorative wall plate with a screwdriver and proceed to remote the in wall dimmer or dimmer.
 - 4) Note the current color of the electrical leads on the existing dimmer: GREEN = GROUND, BLACK = HOT, and in many installations,

BLACK or WHITE may be the color neutral.

- 5) Remove the caps or screws on your existing dimmer to release the wires.

FEATURES

- Remote Controlled Scene Capable—reacts to programmable lighting commands
- No new wiring, simple installation
- LED indicator provides visual on-off status
- 2-way communication shows status confirmation at the controller such as the IWC600 (some remotes/controllers may not have this feature enabled)
- Wireless Monster ControlNet™ system intelligently routes commands throughout the home up to 100ft* between Light Station, Monster Central Controller or other Z-Wave enabled remote
- Compatible with other Monster ControlNet™ and Z-Wave™ enabled controllers/remotes

*Actual range may vary

USING YOUR DIMMER IN MULTI-LIGHT OR MULTI-DEVICE APPLICATIONS

If you'll be installing your Monster IlluminEssence™ dimmer without any other additional IlluminEssence light stations, skip this section and proceed to the next section, "Installing Your Dimmer." If you'll be installing Dimmer in a multi-device application where there will be multiple IlluminEssence dimmers in a single installation location, a reduction of the dimmer's capacity is required. Be sure to check each light fixture to make sure it does not exceed the indicated wattage capacity by itself or as a group of light fixtures.

INSTALLING YOUR DIMMER

STEP 1:

⚠ WARNING: to avoid, fire, shock or death, turn off the power at the circuit breaker or fuse and test that power is OFF before wiring!

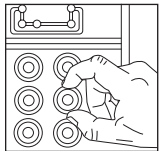
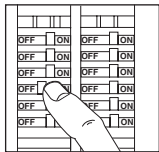

STEP 2:

IDENTIFY YOUR WIRING:

NOTE: This diagram represents a typical single-pole, 2-way wiring configuration. This is for one dimmer controlling one load of lights.

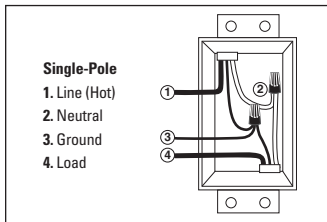

STEP 3:

PREPARING AND CONNECTING WIRES:

This dimmer can be wired using side wire terminal screws or through backwire openings. Choose the appropriate wire stripping specifications accordingly.

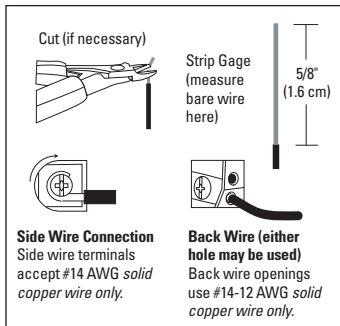

- Make sure that the ends of the wires from the wall box are **straight (cut if necessary)**.
- Remove insulation from each wire in the wall box as shown.

STEP 4:

SINGLE POLE WIRING:

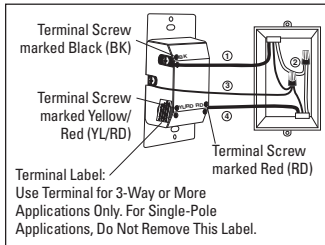

Note: For standard single-pole installations, leave the terminal label untouched.

- "Single Pole" refers to the application of one dimmer or switch to control one or a set of lights on one electrical load.
- Three-way travel wire may be used with the matching Illuminence 3-way auxiliary ON/OFF switch (Not included).

WIRING DIMMER:

Connect wires per **WIRING DIAGRAM** as follows:

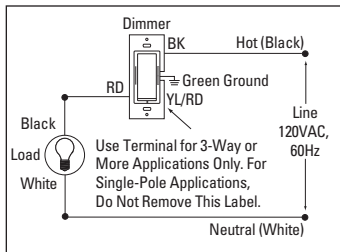

- The Green or bare copper wire in wall box goes to the Green terminal screw.
- Line Hot wall box wire goes to the terminal screw marked "BK".
- Load wall box wire goes to the terminal screw marked "RD".
- Dimmer terminal screw marked "YL/RD" should have Red insulation label affixed.

NOTE: If insulating label is not affixed to terminal screw marked "YL/RD", use electrical tape to cover it.

STEP 5:

TESTING YOUR DIMMER BEFORE MOUNTING

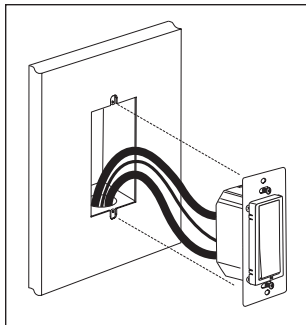

- Position all wires to provide room in outlet wall box for device.
- Ensure that the word "TOP" is facing up on device strap.
- Partially screw in mounting screws in wall box mounting holes.

NOTE: Bend the wires slightly as shown in diagram in order to relieve stress when mounting device.

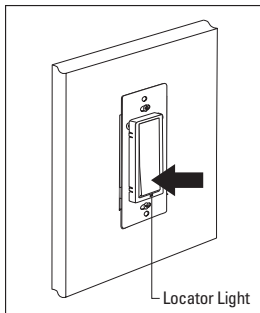

- Restore power at the circuit breaker or fuse.
- Press pad until locator light is OFF. Lights should turn ON.
- If lights do not turn ON, press the upper half of DIM/ BRIGHT bar until the lights brighten.
- If lights still do not turn ON, refer to the TROUBLESHOOTING section.

STEP 6:

PAIRING YOUR ILLUMINESSENCE IN-WALL DIMMER INTO THE NETWORK

- 1) Follow the instructions on your Monster Controller/Programmer to Pair a Monster IlluminEssence™ or other Z-Wave-enabled lighting station into the lighting network. When it's ready to Pair a new device, proceed to Step 2.

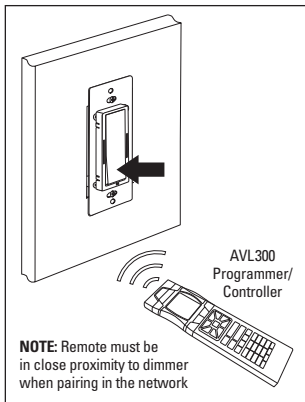

2) While standing close to the dimmer (approximately 2-5 ft.) with the controller in hand, press the center button on the dimmer to Pair it in the network.

NOTE: Only one device may be Paired at a time. **DO NOT** put multiple devices into the Pairing mode at any time.

3) While the Controller/Programmer is in the Pairing mode and the Locator LED is ON on the dimmer, press the push pad to turn on the dimmer. The Programmer/Controller will verify the Pairing and the Locator LED will turn OFF on the dimmer.

4) If the dimmer is flashing Amber while in the Pairing mode, the Programmer/Controller is still trying to communicate with the dimmer. Wait until the device

stops flashing, then press the push the pad.

NOTE: If the Locator LED on the dimmer turns solid Red while Pairing, there has been a communication error. Refer to your ControlNet™ or Z-Wave™ controller manual.

5) The dimmer is now installed in the network.

NOTE: You only Pair a lighting station into the network once. If the dimmer has already been successfully Paired in the network and you try to Pair it again without first Removing it from the network, the dimmer will not pair successfully.

Monster IlluminEssence™ lighting modules use a wireless technology called Monster ControlNet™ that brings your home lighting fixtures into a simplified network. In order for the network to properly recognize each lighting source, each light must be Paired or Included

to the network. This process is necessary for each lighting device you want to add to the network, and you only need to do it once. When you want to Remove a light from your lighting network, you Remove or Exclude that light, so that the network doesn't need to recognize it anymore.

STEP 7:

REMOVING/EXCLUDING AN ILLUMINESSENCE IN-WALL DIMMER FROM THE NETWORK

- 1) Follow the instructions on your Monster Controller/Programmer to Remove a Monster IlluminEssence™ or other Z-Wave-enabled lighting station from the lighting network. When it's ready to Remove the device that you want Removed, proceed to Step 2.
- 2) While standing close to the dimmer (approximately 2-5 ft.) with the controller in hand, press the center button to Remove device from the network.
- 3) While the Programmer/Controller is in the Removal mode and the locator

LED is ON on the dimmer, press the push pad to turn on the dimmer. The Programmer/Controller will verify Removal and the locator LED will turn OFF. If the dimmer is flashing Amber while in the Removal mode, the Programmer/Controller is still trying to communicate with the dimmer. Wait until the device stops flashing, then press the push pad.

When you want to Remove a light from your Monster ControlNet™ system or any wireless Z-Wave network, it is very important to accurately Remove it from the network. This ensures that all information has been Removed from

your Primary Programmer/Controller's information and that unwanted lights are not counted on to be part of the network. Removing/Excluding a light station also clears the light itself making it ready to be Paired into a new network or re-added.

Factory Default:

If your dimmer is not responding, or you are unable to control it after you have tried to Pair or Remove it multiple times, it may be necessary to reset the dimmer to its original factory settings. To do this, proceed as follows:

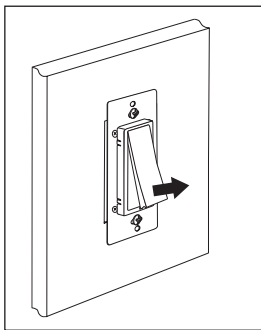

- On the dimmer, engage the air-gap dimmer by gently pulling the bottom of the push pad until it lifts completely out of the frame and a click is heard. **(refer to figure)**. Wait 5 seconds and then press the push pad back into the frame and hold the push pad

until the locator LED flashes Amber and turns solid Red. The dimmer is now reset. Once the dimmer is reset, it will be necessary to re-Pair it to a network before it can be used.

⚠CAUTION: SETTING AN ILLUMINESSENCE LIGHT STATION TO A FACTORY DEFAULT DOES NOT REMOVE IT FROM A NETWORK. THE REMOVAL PROCEDURE MUST STILL BE FOLLOWED TO REMOVE THE LIGHT STATION FROM THE PRIMARY CONTROLLER'S INTERNAL MEMORY. FAILURE TO DO SO MAY RESULT IN SYSTEM THAT IS SLOW TO RESPOND, OR MAY FAIL TO RESPOND TO SOME DEVICES.

STEP 8:

MOUNTING THE DIMMER

- **TURN OFF POWER AT THE CIRCUIT BREAKER OR FUSE!**

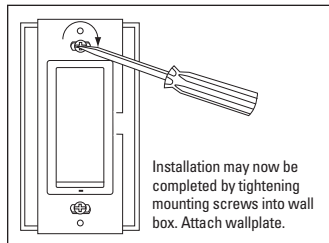

- Install the wall plate by fitting the inner plate over the housing of the dimmer, which will snap into place.
- Install the outer plate by affixing it to the inner plate. The outer plate will snap into place.

STEP 9:

RESTORE POWER

Restore power at circuit breaker or fuse.
Installation is complete.

OPERATION

For complete details on operating your lighting within a Monster ControlNet™ or other Z-Wave-enabled network, refer to the instruction guide of your Monster Central or other lighting controller.

NOTE: The locator light will illuminate when the load is in the OFF position to facilitate access in the dark.

Turn ON from OFF position:

Tap – Lights turn ON to preset level.

Press and Hold – Lights turn ON to full bright.

Turn OFF from ON position:

Tap – Lights turn OFF.

Press and Hold until lights DIM to lowest level and LED in LED Brightness Display starts to blink – Lights remain ON for 10 seconds and then turn OFF.

DIM/BRIGHT Bar BRIGHTEN:

Press upper half of DIM/BRIGHT Bar – Lights brighten to desired level.

DIM:

Press lower half of DIM/BRIGHT Bar – the light will dim to the desired level. If you continue to hold the lower half of the DIM/BRIGHT Bar, the lights will DIM to minimum level and then turn OFF.

NOTE: When lights are OFF you can change the light level that the lights will turn ON to using the DIM/BRIGHT Bar. In the event of a power outage, when the power is restored the lights will return to the last setting before the power interruption.

NOTE: The locator light will illuminate when the load is in the OFF position to facilitate access in the dark.

Status and Operational Indicators:

When operating your system manually, the status indicator of your Monster IlluminEssence light station will inform you as follows:

- If the light in question is currently off, the LED status indicator bar indicates

what level the light will return when you turn it back on.

- If the light in question is currently is currently on, the indicator shows the brightness level that the dimmer is currently set to.
- The toggle dim bar on the right hand side of the dimmer will dim the brightness up or down if the light is on.
- If the light in question is currently off, the toggle dim bar can change the preset level that the light will go to when it is turned on.

Air-Gap Dimmer: On the dimmer, engage the air-gap dimmer by gently pulling the bottom of the push pad until it lifts completely out of the frame and a click is heard and all LED's are OFF (**refer to Figure**). This will cut power to the fixture to replace the bulb. After servicing is complete, push the push pad back for normal operation.

Cleaning: Clean with a damp cloth. **DO NOT** use chemical cleaners.

ADVANCED PROGRAMMING FEATURES

Your Monster IlluminEssence™ in-wall dimmer is capable of personalized operations that will bring your lighting to your preferred settings under a variety of everyday situations and conditions:

Advanced Features Summary

| Mode | Description | Range | Default |
|------|---------------------|--------------------------|-----------|
| 1 | Set Min. Brightness | 1-50% | 25% |
| 2 | Set Dim-Lock Level | 0-100%, 0=no lock | 0 |
| 3 | Select Fade Rate | 1, 2, 3, 4, 5, 6 or 7 | Preset #1 |

Mode 1 – Set Minimum Brightness:

You can set the minimum brightness level that the lights can dim to prior to turning full OFF.

Mode 2 – Set Dim-Lock: You can set the brightness level that the lights will turn on to regardless of the previous light level at which they were when last turned OFF.

Mode 3 – Set Fade Rate: You can set the amount of time (in seconds) that the lights

will take to turn ON or OFF. These “fade” rates can be set to one of 7 different settings.

TO PROGRAM MODE SETTINGS:

NOTE: Have a flashlight handy if this dimmer controls the only light source in the room.

- 1) On the dimmer, engage the air-gap dimmer by gently pulling the bottom of the push pad out of the frame until a click is heard, and all LEDs are OFF.
- 2) Press the push pad back into the frame and hold the push pad for 7 seconds until the locator light and the top LED (LED 1) starts blinking.
- 3) Upon releasing the push pad, the locator light will continue to blink once per second, indicating the dimmer is in Mode 1, Set the Minimum Brightness mode. To change the current Minimum Brightness level from 1-50%, use the DIM/BRIGHT Bar. This setting will automatically be saved.

Fade Rate Presets

| Preset | LED** | Fade On | Fade Off |
|--------|-------|----------------------------|---------------------------|
| 1* | 1 | Approx. 1.5s from full off | Approx. 3s from full on |
| 2*** | 2 | No Fade | No Fade |
| 3 | 3 | No Fade | Approx. 3s from full on |
| 4 | 4 | Approx. 0.5s from full off | Approx. 3s from full on |
| 5 | 5 | Approx. 0.5s from full off | Approx. 1.5s from full on |
| 6 | 6 | Approx. 1.5s from full off | Approx. 5s from full on |
| 7 | 7 | Approx. 1.5s from full off | Approx. 10s from full on |

* default

** LED #1 is located at the top

*** The press and hold feature for the 10 second delayed off is disabled in this mode.

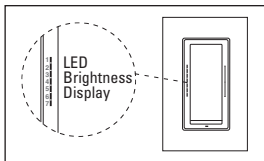

- 4) Tap the push pad to change to Mode 2, Set Dim-Lock Level mode. The locator light will blink twice per second. To change the current Set

Dim-Lock level from 1-100%, use the DIM/BRIGHT Bar. If this feature is not desired, press and hold the lower half of the DIM/BRIGHT Bar until no LED is lit. This setting will automatically be saved.

- 5) Tap the push pad to change to Mode 3, Set Fade Rate mode. The locator light will blink 3 times per second. To change the current Fade Rate, use the DIM/BRIGHT Bar to move the LED to the desired preset level. This setting will automatically be saved by tapping the push pad to exit the programming mode.

The LED Brightness Display is separated into 7 segments. Each LED represents a preset level with LED 1 (Preset 1) located at the top and LED 7 (Preset 7) located at the bottom. Refer to chart below for settings and defaults.

NOTE: The dimmer will exit program mode after 3 minutes of inactivity.

TROUBLESHOOTING

LIGHTS ARE FLICKERING.

- Lamp has a bad connection.
- The wires are not secured firmly under terminal screws of dimmer and/or remote.
- The lamp may not be designed for true dimmable control such as non-dimmable fluorescent lighting.

LIGHT DOES NOT TURN ON AND LOCATOR LED DOES NOT TURN ON

- Circuit breaker or fuse has tripped.
- Lamp is burned out.
- Lamp Neutral connection is not wired.
- Confirm that the device is being supplied from a 120V, 60Hz AC source ONLY.
- Confirm that unit is programmed properly. Repeat "TO INSTALL" section to verify that it has been Paired in the ControlNet™ or other Z-Wave network.

INTERMITTENT DIMMER OPERATION

- Minimum load is under 40W.
- Confirm that the light(s) being controlled do not exceed the rated dimmer capacity

LIGHT CANNOT BE PAIRED/ INCLUDED INTO MONSTER CONTROLNET CONTROLS

- Use controller to delete or Remove the light station

CONTROLLER DOES NOT OPERATE LIGHTS

- Ensure that total wire length does not exceed 300 ft. from your IWD 600S and your light fixture.

LIGHT DOES NOT TURN ON AND LOCATOR LED DOES NOT TURN ON

- The circuit breaker or fuse may have tripped.
- The lamp is burned out.
- The lamp Neutral connection is not wired.

FCC COMPLIANCE STATEMENT

This equipment has been tested and found to comply with the limits for a Class B Digital Device, pursuant to Part 15 of the FCC Rules. These limits are designed to provide reasonable protection against harmful interference in a residential installation. This equipment generates, uses, and can radiate radio frequency energy and, if not installed and used in accordance with the instructions, may cause harmful interference to radio communications. However, there is no guarantee that interference will not occur in a particular installation. If this equipment does cause harmful interference to radio or television reception, which can be determined by turning the equipment OFF and ON, the user is encouraged to try to correct the interference by one or more of the following measures:

- Reorient or relocate the receiving Antenna.
- Increase the separation between the equipment and the receiver.
- Connect the equipment into an outlet on a circuit different from that to which the receiver is connected.
- Consult the dealer or an experienced radio/tv technician for help.

LIMITED WARRANTY FOR CONSUMERS

Monster, LLC, 7251 West Lake Mead Blvd., Suite 342, Las Vegas, NV 89128, USA, (415) 840-2000 (“Monster”) extends You this Limited Warranty. Statutory or common law may provide You with additional rights or remedies, which shall not be affected by this Limited Warranty.

DEFINITIONS

“Adequate Use” means use of the Product (i) within a home or dwelling, (ii) for private (as opposed to commercial) purposes, (iii) in conformance with all applicable local, state or federal law, code or regulations (including without limitation building and/or electrical codes), (iv) in accordance with manufacturer recommendations and/or instructions in the materials and documentation that accompany the Product, and (v) with proper electrical grounding.

“Authorized Dealer” means any distributor, reseller or retailer that (i) was duly authorized to do business in the jurisdiction where it sold the Product to You, (ii) was permitted to sell You the Product under the laws of the jurisdiction where You bought the Product, and (iii) sold You the Product new and in its original packaging.

“Formal Warranty Claim” means a claim made in accordance with the section “Formal Warranty Claims” herein.

“Product” means a Product (i) that is listed in the Specifications Table below, (ii) that You bought from an Authorized Dealer new and in its original packaging, and (iii) whose serial number, if any, has not been removed, altered, or defaced.

“Product Defect” means an inadequacy of the Product that existed at the time when You received the Product from an Authorized Dealer and that causes a failure of the Product to perform in accordance with Monster’s documentation accompanying the Product, unless such failure has been caused completely or partly by (a) any use other than Adequate Use, (b) transportation, neglect, misuse or abuse by anyone other than Monster’s employees; (c) alteration, tampering or modification of the product by anyone other than a Monster employee; (d) accident (other than a malfunction that would otherwise qualify as a Product Defect); (e) maintenance or service of the Product by anyone other than a Monster employee; (f) exposure of the Product to heat, bright light, sun, liquids, sand or other contaminants; or (g) acts outside the control of Monster, including without limitation acts of God, fire, storms, earthquake or flood.

“Warranty Period” means the time period during which Monster must have received Your Formal Warranty Claim. The different Warranty Periods related to Product Defects are defined in the Specifications Table below. The Warranty Period commences on the date when You purchased or received (whichever occurs later) the Product from an Authorized Dealer as evidenced by the Authorized Dealer’s invoice, sales receipt or packing slip. If You do not have written proof of the date of purchase or receipt, then the Warranty Period commences three (3) months after the date when the Product left Monster’s or its factory as evidenced by Monster’s records. The Warranty Period ends after the time defined in the Specifications Table has expired or after You have transferred ownership of the Product, whichever occurs earlier. Also, You must call Monster and obtain a Return Authorization Number (as described under “How to Make a Claim”) within two (2) months after You discover a Product Defect (or should have discovered it, if such Product Defect was obvious).

“You” means the first individual person that purchased the Product in its original packaging from an Authorized Dealer. This Limited Warranty does not apply to persons or entities that bought the Product (i) in used or unpackaged form, (ii) for resale, lease or

other commercial use, or (iii) from someone other than an Authorized Dealer.

SCOPE OF THIS LIMITED WARRANTY

PRODUCTS. If a Product contained a Product Defect when You bought it from an Authorized Dealer and Monster receives a Formal Warranty Claim from You within two (2) months after You discover such Product Defect (or should have discovered it, if such Product Defect was obvious) and before the end of the Warranty Period for Product Defects applicable to the affected Product, then Monster will provide You with one of the following remedies: Monster will (1) repair or, at Monster's sole discretion, replace the Product, or (2) refund to You the purchase price You paid to the Authorized Dealer for the affected Product if repair or replacement is not commercially practicable or cannot be timely made. NOTE: MONSTER DOES NOT ASSUME ANY LIABILITY FOR ANY INCIDENTAL, CONSEQUENTIAL OR INDIRECT DAMAGES UNDER THIS LIMITED WARRANTY.

GENERAL PROVISIONS

CHOICE OF LAW/JURISDICTION.

This Limited Warranty and any disputes arising out of or in connection with this Limited

Warranty ("Disputes") shall be governed by the laws of the State of California, USA, excluding conflicts of law principles and excluding the Convention for the International Sale of Goods. The courts located in the State of California, USA shall have exclusive jurisdiction over any Disputes.

OTHER RIGHTS. THIS LIMITED WARRANTY GIVES YOU SPECIFIC LEGAL RIGHTS, AND YOU MAY ALSO HAVE OTHER RIGHTS, WHICH VARY FROM STATE TO STATE AND JURISDICTION TO JURISDICTION, AND WHICH SHALL NOT BE AFFECTED BY THIS LIMITED WARRANTY. THIS WARRANTY EXTENDS ONLY TO YOU AND CANNOT BE TRANSFERRED OR ASSIGNED. If any provision of this Limited Warranty is unlawful, void or unenforceable, that provision shall be deemed severable and shall not affect any remaining provisions. In case of any inconsistency between the English and other versions of this Limited Warranty, the English version shall prevail.

REGISTRATION. Please register Your Product at MonsterCentral.com. Failure to register will not diminish Your warranty rights.

SPECIFICATIONS TABLE

| Product Model | Warranty Period for Product |
|---------------|-----------------------------|
| MLIWD 600S | Three (3) Years |

FORMAL WARRANTY CLAIM

HOW TO MAKE A CLAIM. In the event damage has occurred to Products, You must follow these instructions: (1) Call Monster within two (2) months after You discover a Product Defect (or should have discovered it, if such Product Defect was obvious); (2) Give a detailed explanation of how the damage occurred; (3) Obtain a Return Authorization Number; (4) Upon receipt of a claim form (which may be sent to You after You filed Your Formal Warranty Claim), fill out the claim form entirely; (5) Return the Products, shipping prepaid by You (to be refunded if You are entitled to a remedy under the Scope of this Limited Warranty), to Monster for verification of damage, along with a copy of Your original sales receipts and proof of purchase (UPC label or packing slip) for such Products, the completed claim form, and printed Return Authorization Number on the outside of the return package (the claim form will include instructions for return).

TELEPHONE NUMBERS. United States, Asia Pacific and Latin America: 1 877 800-8989 or 415-840-2000, Canada 1-866-348-4171, Czech Republic 800-14247, UK 0800 0569520, Germany 0800 1819388, France 0800 918201, Netherlands 0800 0228919, Belgium 0800 79201, Norway 800 10906, Denmark 8088 2128, Sweden 020 792650, Finland 800 112768.

FURTHER PROCEEDINGS. Monster will determine whether a Product Defect existed. Monster may, at its discretion, direct You to obtain a repair estimate at a service center. If a repair estimate is required, You will be instructed on how to properly submit the estimate and the resulting invoice to Monster for payment. Any fees for repairs may be negotiated by Monster.

TIMING. If You bring a Formal Warranty Claim and fully comply with all terms and conditions of this Limited Warranty, Monster will use its best efforts to provide You with a remedy within thirty (30) days after receipt of Your Formal Warranty Claim (if You reside in the United States – forty-five (45) days if You reside elsewhere), unless obstacles outside Monster's control delay the process.

Ver.121703 – US/EU
©2003 Monster, LLC



IlluminEssence™
ADVANCED LIGHTING SYSTEMS

MonsterCentral.com

© 2006 Monster, LLC
7251 West Lake Mead Blvd.
Las Vegas, NV 89128, USA
1-877-800-8989

Monster Central products are designed
in the USA and manufactured for Monster
to its quality specifications.

Manufactured in Mexico.

Monster, Monster Central, the Monster
Central logo and the product design,
Omnalink, Monster System Tracking Memory,
IlluminEssence, ControlNet, are registered
or unregistered trademarks of Monster Cable
Products, Inc. or its subsidiaries
in the US and other countries.

rm 162839